

Venue kit

2021



Hash Marihuana & Hemp Museum



Barcelona

Presentation

In May 2012, the Hash Marihuana & Hemp Museum of Barcelona, located in Palau Mornau - a stunning city palace built in the 16th century - opened its doors to the public.

Aiming to change the world

The museum, just like the Hash Marihuana & Hemp Museum in Amsterdam, is a unique permanent exhibition. It shows the past, present and future of the cannabis plant and its unmatched potential as a versatile resource for industrial, nutritional, medicinal, sacramental and recreational purposes. The museum's collection is composed of rare artefacts related to all aspects of cannabis history and culture, which its founder Ben Dronkers continues to gather from around the world.

A palace with lineage

The Palau Mornau dates back to the 16th century and originally consisted of two buildings. The Mornau family bought the whole property in the late 18th century and in the early 20th century it was entirely renovated by the Modernista architect Manuel Raspall. In 2002, Dutch entrepreneur and philanthropist Ben Dronkers bought the Paulau Mornau, which was in a deplorable state. Architect Jordi Romeu, together with a team of constructors and artists, needed 10 years to entirely refurbish the palace and restore the grace and beauty it once had.

The collection

The museum presents valuable paintings and prints depicting cannabis use throughout history, and rare antiques, such as the various tools and implements used to make hemp into rope, paper and fabrics. Art lovers will be delighted by the original paintings by noted 17th century artists David Teniers the Younger, Cornelis Decker and Herman Saftleven. This important collection of old masters is complemented by a wide array of botanical prints from the 18th and 19th centuries. A medicinal section testifies to the widespread use of medicinal cannabis in the past. It features one of the world's largest collections of medicinal cannabis bottles from the 19th century.

Floor plan Palau Mornau

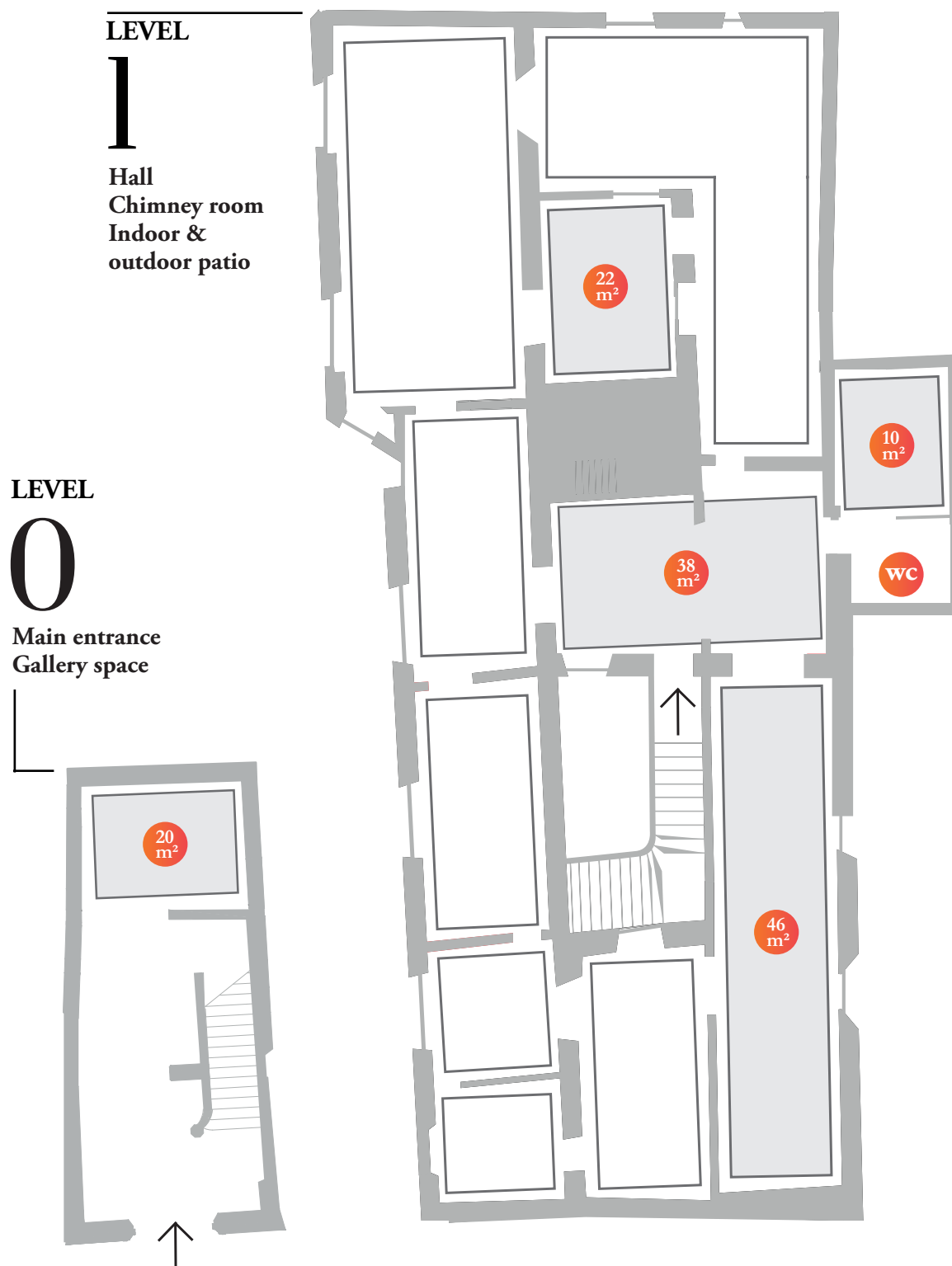





Venue rental

The museum welcomes companies and professionals to enjoy the rooms of its Modernista palace. These are exceptional spaces, ideal for special celebrations such as gala dinners, press conferences, presentations, and cocktail evenings.

Chimney room

Size: 46 m² (11,5 x 4 m)

Cocktail: 70 persons. Banquet: 40 persons

Fee: 1.000 € (500 € for press conference)

Hall (with bar)

Size: 38 m² (9,5 x 4 m)

Event with DJ or acoustic music: 30 persons

Fee: 500 €

Indoor patio

Size: 22 m² (5 x 4,5 m)

Cocktail: 20 persons

Fee: 750 €

Services

Entrance to the museum + guided tour + glass of cava: 25 € per person

Guide for exclusive guided tours: 30 € per hour

Security guard: 35 € per hour (one guard for 20-40 persons)

Waiter/waitress: 30 € per hour, sound technician: 100 € per session

The museum has a maximum capacity of 170 persons. Smoke-free environment.

For catering services the outdoor patio (10 m²) is used, which requires protection with pallets placed on the ground. This is not included in the venue rental.

Venue rental whole day: on request. Venue rental with museum closed to the public: on request.

* Limited capacity of 70 percent in line with current health and safety measures regarding COVID-19.

Practical information

Contact details

Hash Marihuana & Hemp Museum

Carrer Ample 35 · 08002 Barcelona

(+34) 93 319 75 39

barcelona@hashmuseum.com

www.hashmuseum.com



@hempmuseumgallery



@hashmuseum

Accessibility

Unfortunately, due to the nature of the Palau Mornau and the fact that it is a national monument, the museum is not yet able to provide easy access for people with limited mobility.

How to get there

The Palau Mornau is located close to Barcelona's famous Ramblas. When walking towards the port, turn left on Carrer Josep Anselm Clavé before the Columbus monument, and continue down the street for approximately five minutes.

An alternative route is to access Carrer Ample from the bottom of Via Laietana. Take to the left of the Correos central post office. Carrer Ample will be the second street to your left.

Public transport

Nearest metro stations:

Jaume I – Line 4 (yellow)

Drassanes – Line 3 (green)

Membership



RUTA DEL
MODERNISME



ART NOUVEAU EUROPEAN ROUTE
RUTA EUROPEA DEL MODERNISME



Barcelona
Turisme



MONUMENTA